



Greenfield Drive, Eaglescliffe, Stockton-On-Tees, TS16 0HE

Situated on the popular Orchard Estate development in Eaglescliffe is a three-bedroom detached property with garage and south facing garden. This property is ready for updating and gives an excellent starting point to create a special home.

To the ground floor, the accommodation comprises hall leading to a bright, spacious living/dining room and kitchen. To the first floor are three bedrooms and bathroom with separate W/C.

Externally is a lawned front garden and off-road parking is available to the front driveway for one vehicle, leading to the single garage. To the rear is a good sized, south facing lawned garden.

Conveniently located near reputable schools and local amenities, with easy access to the A66, Allens West Train Station, and Teesside International Airport this property could be a perfect family home.

Asking Price £210,000



Greenfield Drive, Eaglescliffe, Stockton-On-Tees, TS16 0HE

HALL

LIVING/DINING ROOM

12'1 x 25 (3.68m x 7.62m)

KITCHEN

7'11 x 14'2 (2.41m x 4.32m)

LANDING

BEDROOM ONE

11'6 x 13'5 (3.51m x 4.09m)

BEDROOM TWO

11'6 x 10 (3.51m x 3.05m)

BEDROOM THREE

8'10 x 6'11 (2.69m x 2.11m)

BATHROOM

6'11 x 5'6 (2.11m x 1.68m)

W/C



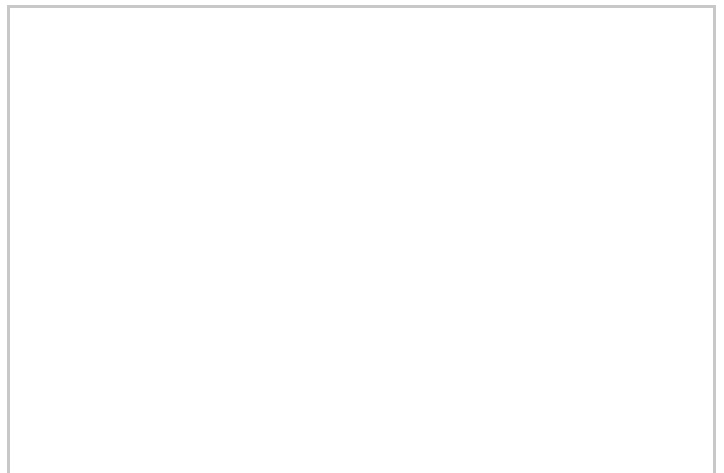

Map

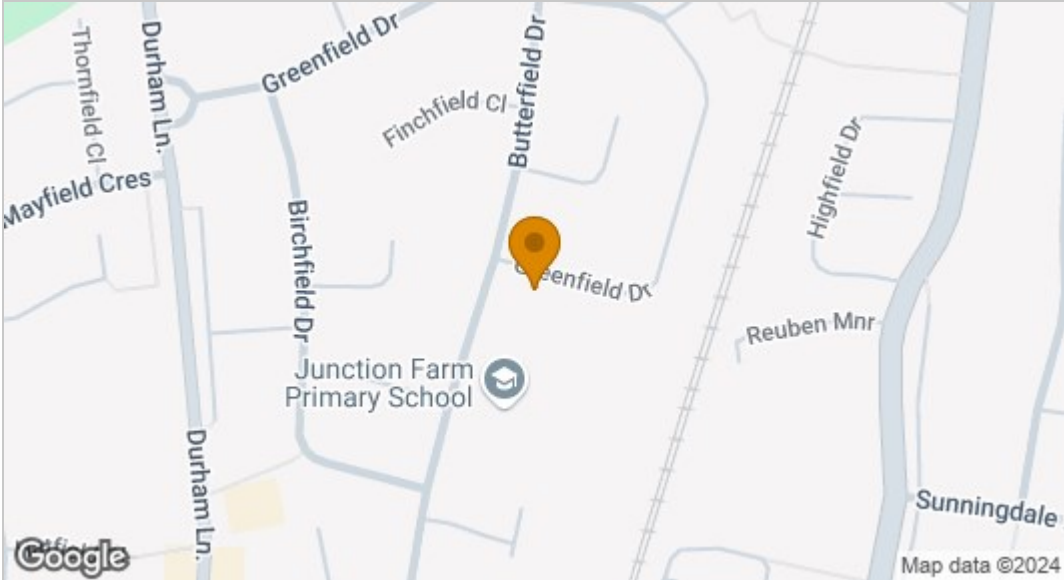

EPC graph

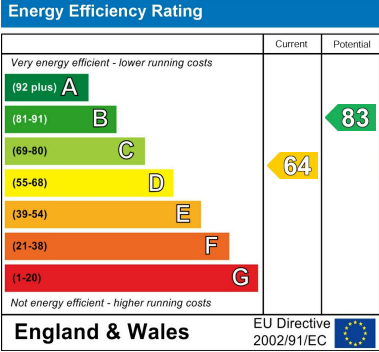

Floor Plan

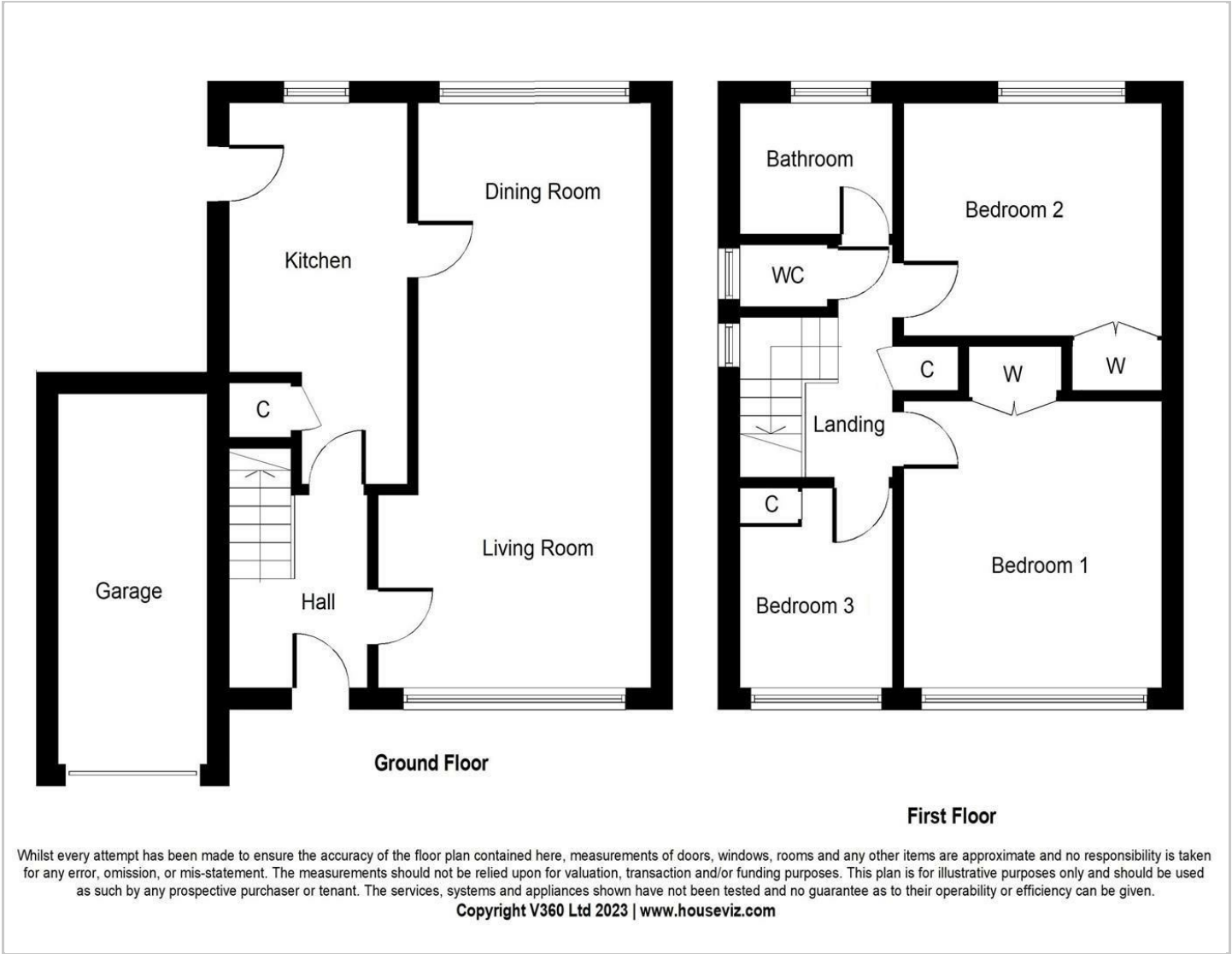

VIEWING

Please contact us on 01642 248248 if you wish to arrange a viewing or would like more information.

These particulars, whilst believed to be accurate are set out as a general outline only for guidance and do not constitute any part of an offer or contract. Intending purchasers should not rely on them as statements of representation of fact, but must satisfy themselves by inspection or otherwise as to their accuracy. No person in this firms employment has the authority to make or give any representation or warranty in respect of the property.